

FOUNDATION PLANTINGS 1
TYPICAL OF 18

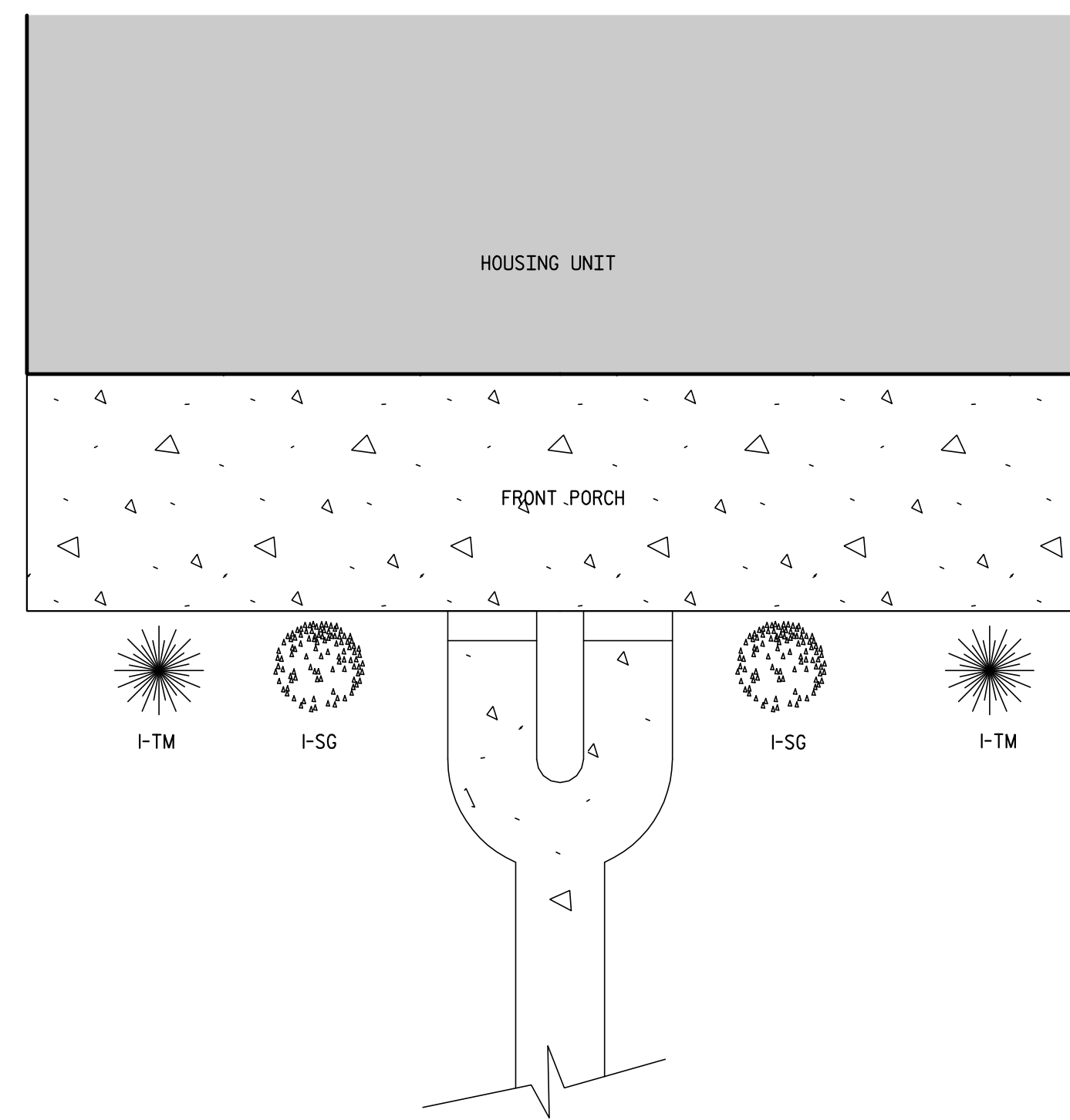

FOUNDATION PLANTINGS 2
TYPICAL OF 33

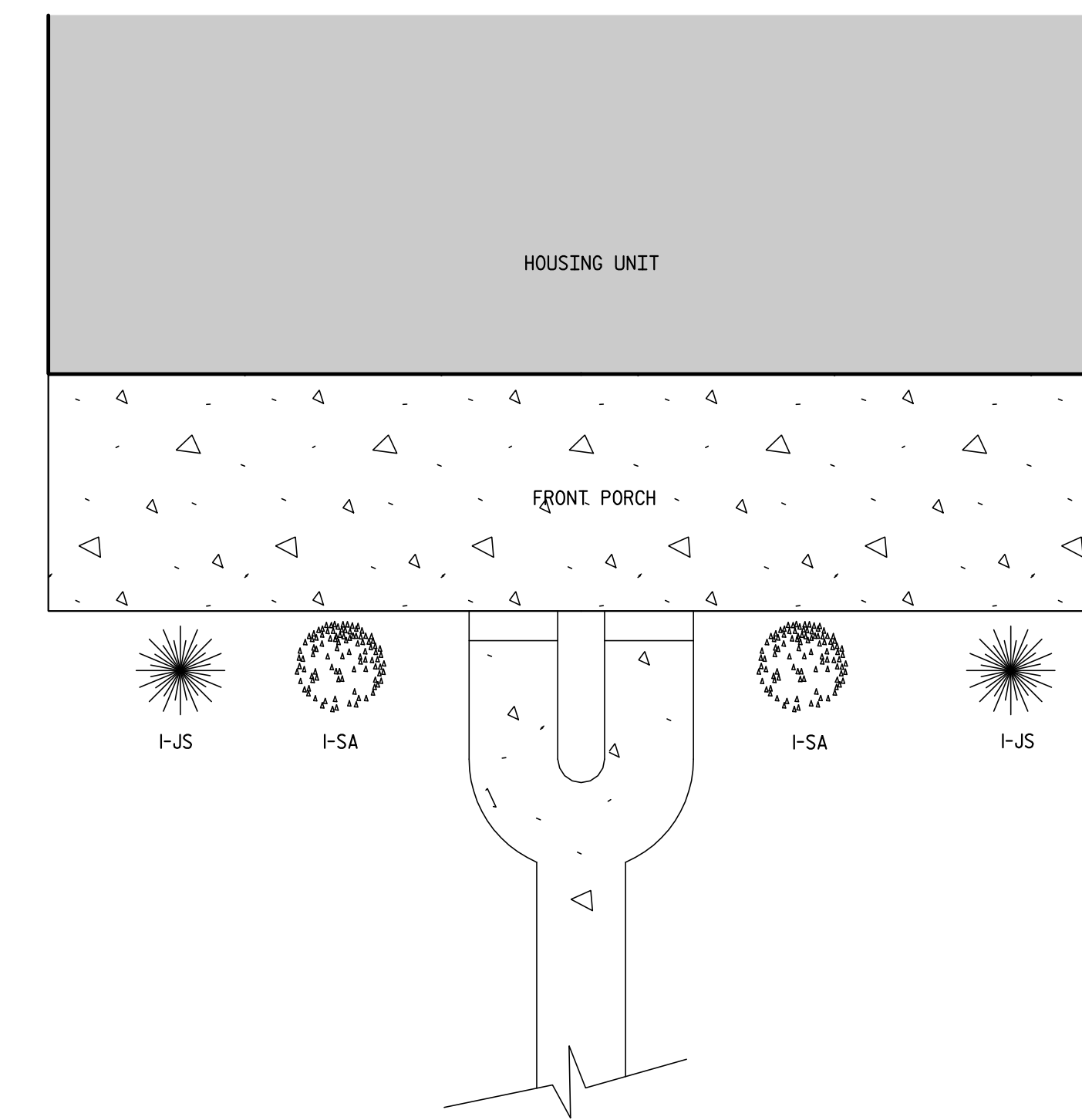

FOUNDATION PLANTINGS 3
TYPICAL OF 16

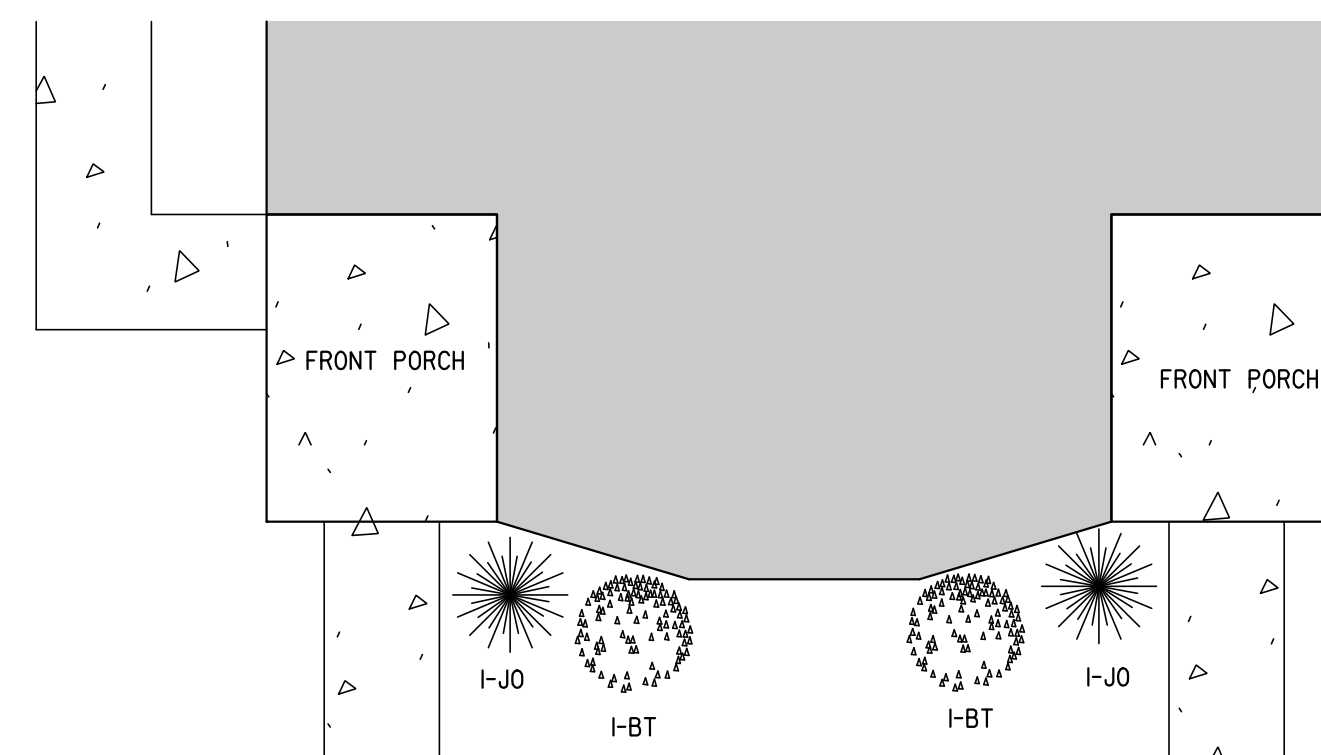

FOUNDATION PLANTINGS 4
TYPICAL OF 2

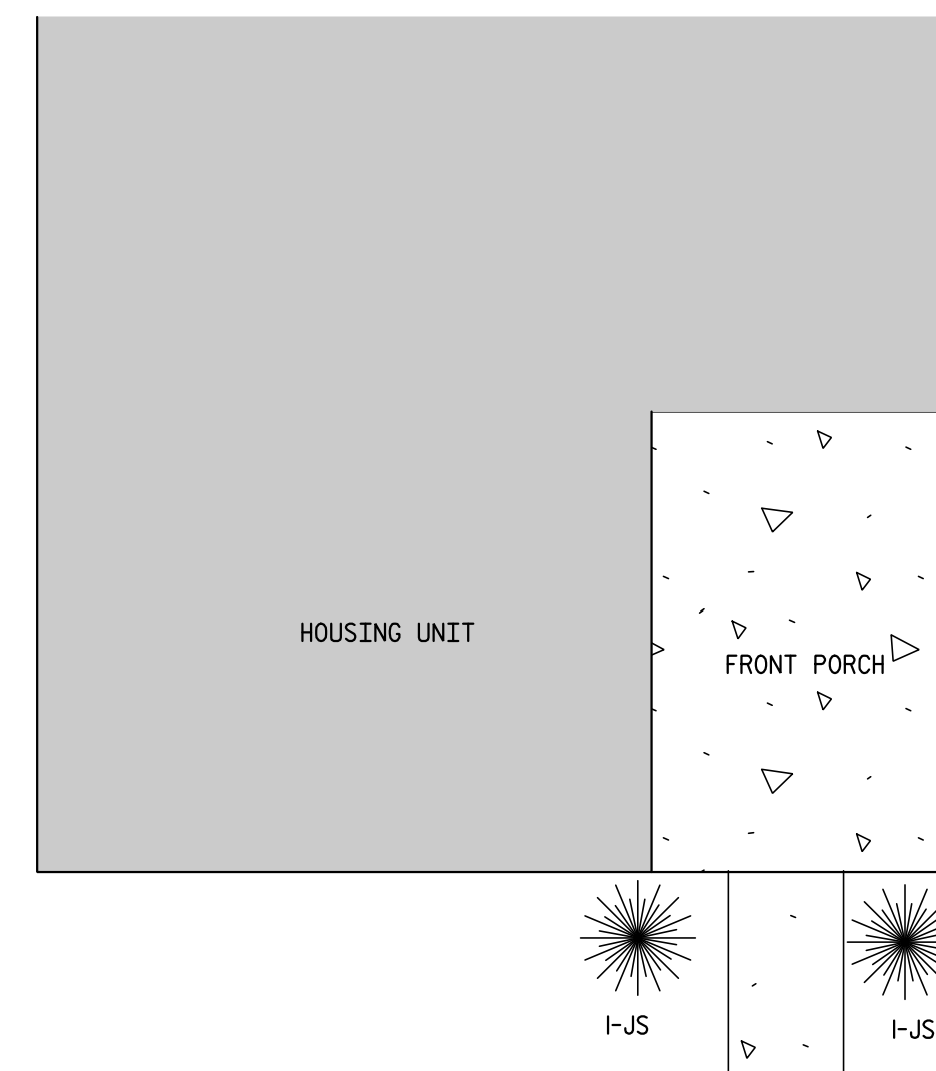

FOUNDATION PLANTINGS 5
TYPICAL OF 3

PLANTING LIST

KEY	QTY.	BOTANICAL NAME	COMMON NAME	MINIMUM SIZE	ROOT
AR	25	Acer Ginnala "Amur Maple"	Amur Maple	2 1/2" Caliper	B&B
GT	24	Gleditsia Triacanthos Inermis "Skyline"	Skyline Honeylocust	2 1/2" Caliper	B&B
PC	14	Pyrus Calleryana "Cleveland Select"	Cleveland Select Pear	2 1/2" Caliper	B&B
TC	6	Tilia Cordata "Greenspire"	Greenspire Linden	2 1/2" Caliper	B&B
BT	32	Berberis Thunbergii "Atropurpurea Nana"	Crimson Pygmy Barberry	18-24"	CONT.
JO	32	Juniperus Chinensis "Old Gold"	Old Gold Juniper	18-24"	CONT. or B&B
JS	32	Juniperus Chinensis "Sea Green"	Sea Green Juniper	18-24"	CONT. or B&B
SA	26	Spiraea Bumalda "Anthony Waterer"	Anthony Waterer Spirea	18-24"	CONT.
SG	58	Spiraea Bumalda "Gold Flame"	Gold Flame Spirea	18-24"	CONT.
TM	58	Taxus Media "Densiformis"	Dense Japanese Yew	18-24"	B&B

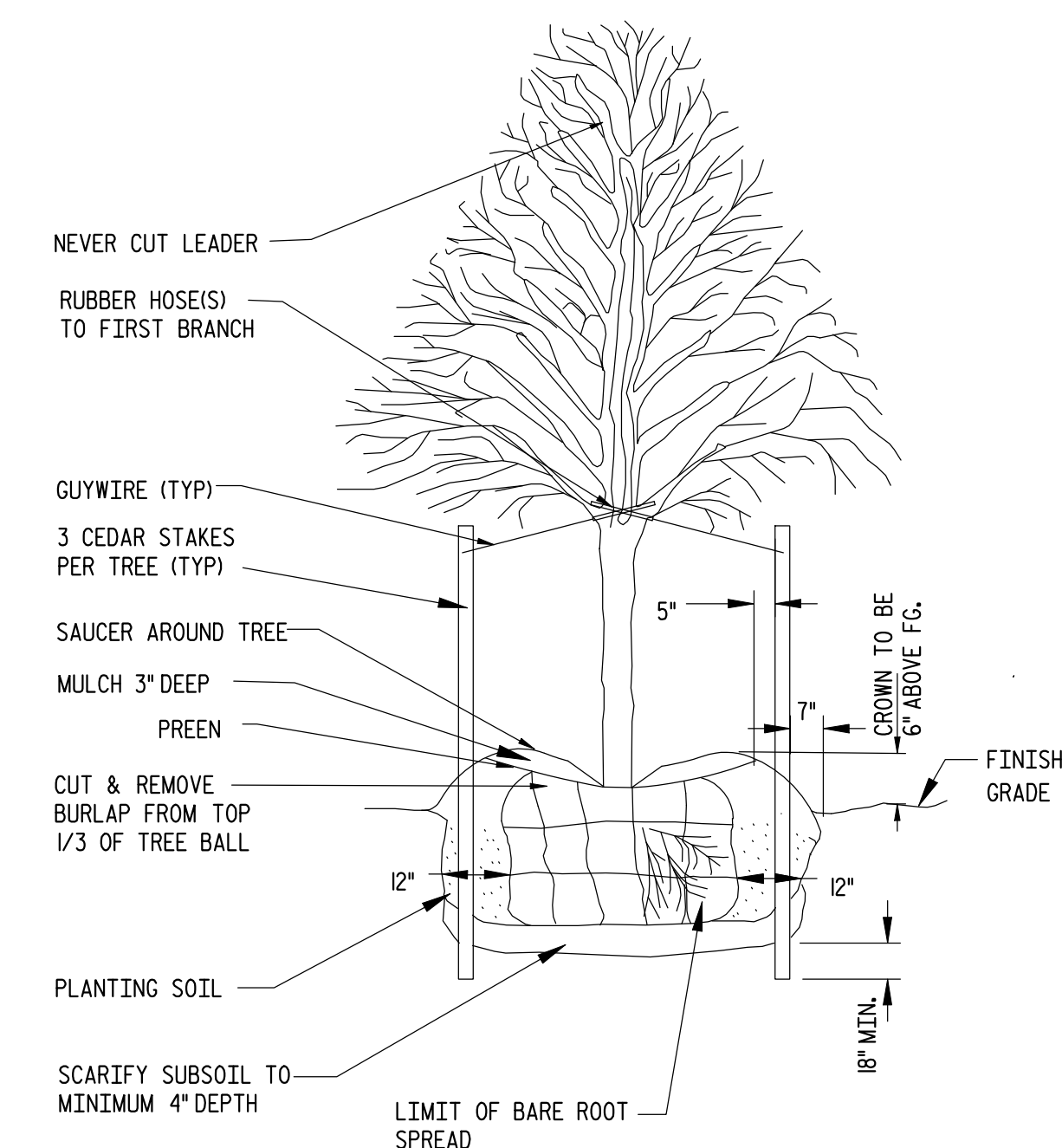

TREE PLANTING DETAIL

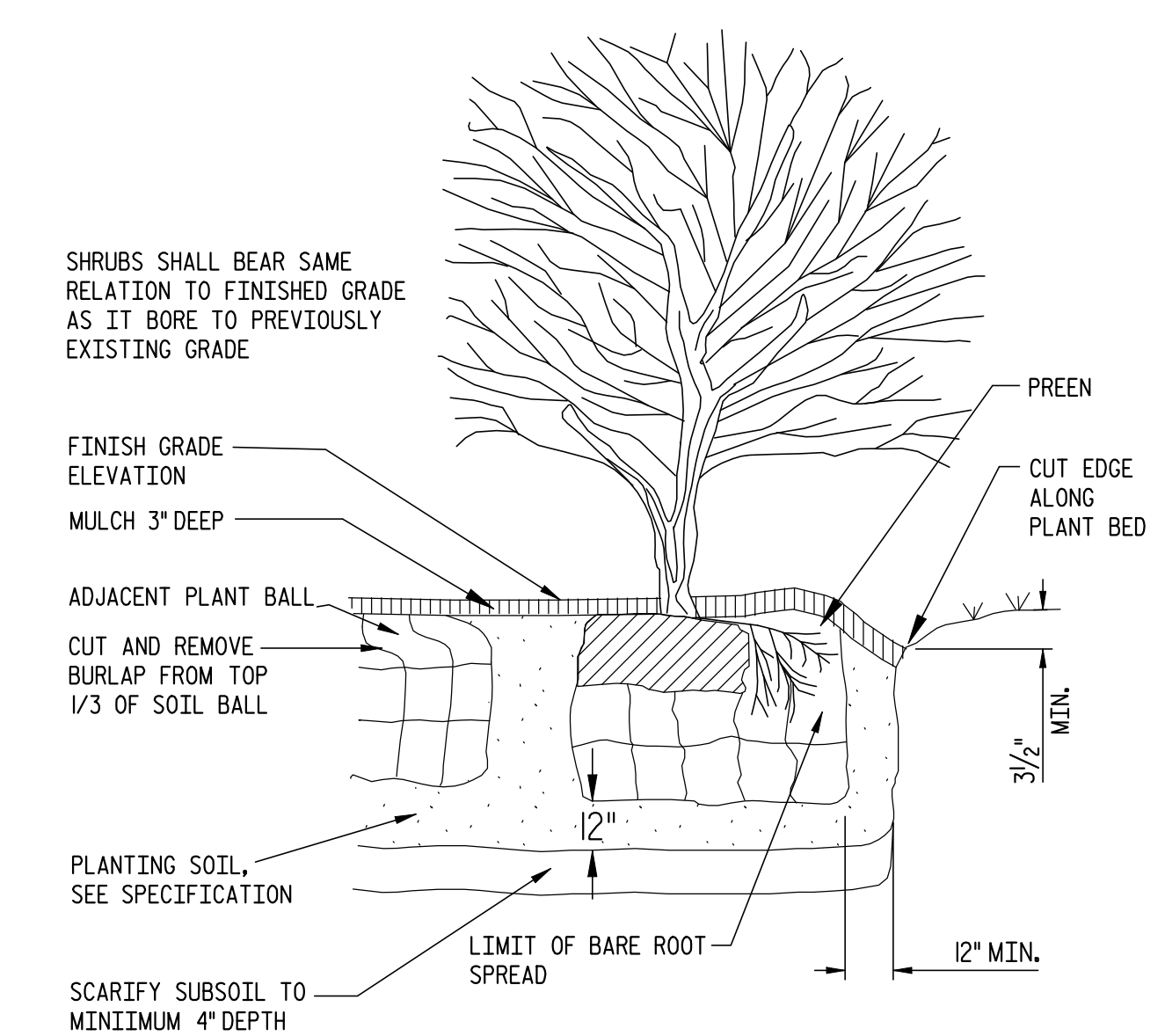

SHRUB PLANTING DETAIL

FOUNDATION PLANTINGS & PLANT LIST
CENTER COURT REVITALIZATION
NIAGARA FALLS, NEW YORK

REVISIONS		
MARK	DATE	DESCRIPTION
	07/01/07	REVIEW COMMENTS
	07/22/07	HOMEOWNERSHIP CHANGES
	11/20/07	REVISED ALLEY #1
	11/27/07	100% SUBMITTAL
	3/5/08	CONSTRUCTION DRAWINGS
	4/14/08	ROW/PL. LINE REVISIONS

PROJECT NO: F58.001.001
CADD FILE NO: 2147BL29.DGN
DATE: AUGUST 12, 2007
SCALE: AS NOTED
DRAWN BY: TEAM
CHECKED BY: L. DEWEY

NO ALTERATION PERMITTED HEREON EXCEPT AS PROVIDED UNDER SECTION 7209 SUBDIVISION 2 OF THE NEW YORK EDUCATION LAW